

REMOVAL

1. DISCONNECT CABLE FROM NEGATIVE BATTERY TERMINAL

CAUTION:

Wait at least 90 seconds after disconnecting the cable from the negative (-) battery terminal to prevent airbag and seat belt pretensioner activation.

2. REMOVE NO. 1 ENGINE UNDER COVER
3. REMOVE FRONT FENDER APRON RH
4. REMOVE RADIATOR SUPPORT OPENING COVER
5. DRAIN ENGINE COOLANT (See page [CO-6](#))
6. REMOVE FRONT SUSPENSION MEMBER REINFORCEMENT RH (See page [EM-6](#))
7. REMOVE FAN AND GENERATOR V BELT (See page [EM-6](#))
8. REMOVE GENERATOR ASSEMBLY (See page [CH-9](#))
9. REMOVE WATER PUMP PULLEY
 - (a) Using SST, remove the 4 bolts and water pump pulley.
SST 09960-10010 (09962-01000, 09963-00700)

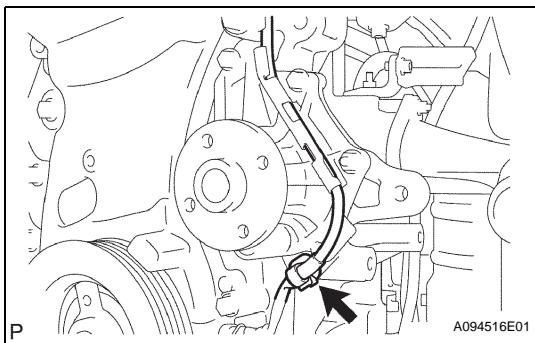
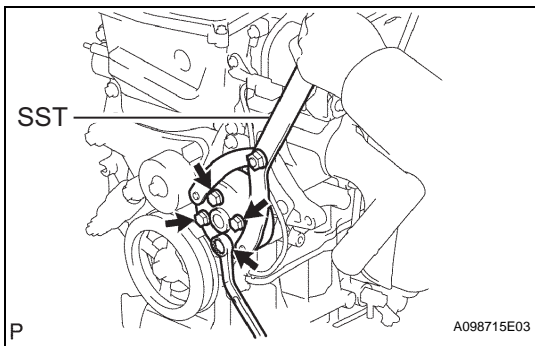

10. REMOVE WATER PUMP ASSEMBLY

- (a) Remove the clamp of the crankshaft position sensor from the water pump.
- (b) Disconnect the wire of the crankshaft position sensor from the clamp bracket.

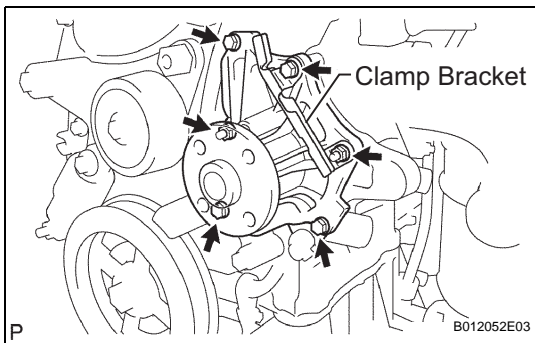

- (c) Remove the 4 bolts, 2 nuts and clamp bracket.

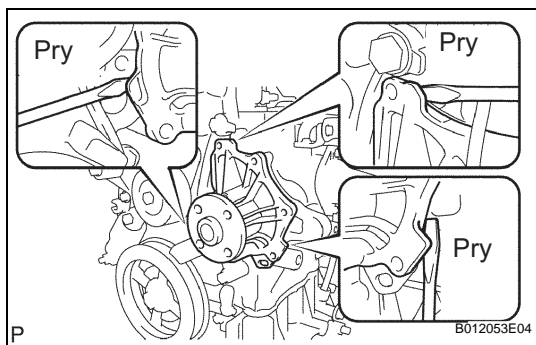

- (d) Using a screwdriver, pry between the water pump and cylinder block, and then remove the water pump.

NOTICE:

Be careful not to damage the contact surfaces of the water pump and cylinder block.

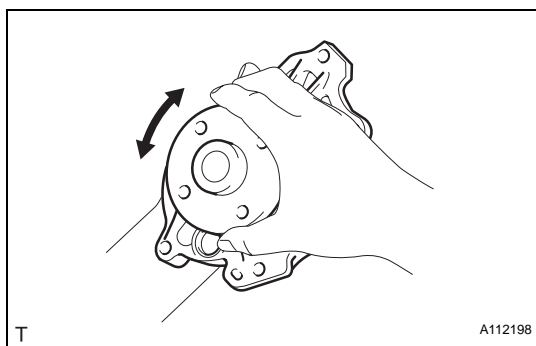

INSPECTION

1. INSPECT WATER PUMP ASSEMBLY

- (a) Visually check the drain hole for coolant leakage. If leakage is found, replace the water pump assembly.
- (b) Turn the pulley, and then check that the water pump bearing moves smoothly without making a "click" noise. If it does not move smoothly, replace the water pump assembly.