

# FRONT DOOR BELT MOULDING REPLACEMENT

7615S-01

## HINT:

- The installation procedures are the removal procedures in reverse order.
  - Use the same procedures for the RH side and LH side.
  - The procedures listed below are for the LH side.
1. REMOVE FRONT DOOR INSIDE HANDLE BEZEL LH (See page 75-9)
  2. REMOVE FRONT DOOR LOWER FRAME BRACKET GARNISH LH (See page 75-9)
  3. REMOVE DOOR PULL HANDLE (See page 75-9)
  4. REMOVE FRONT ARMREST BASE PANEL UPPER LH (See page 75-9)
  5. REMOVE FRONT DOOR TRIM BOARD SUB-ASSY LH (See page 75-9)
  6. REMOVE OUTER REAR VIEW MIRROR ASSY LH (See page 75-9)

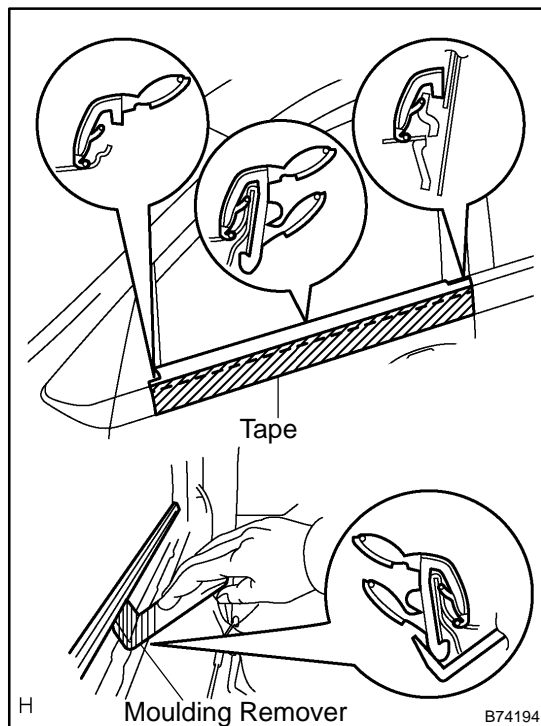

## 7. REMOVE FRONT DOOR BELT MOULDING

- (a) Put protective tape under the moulding.
- (b) Using a moulding remover, pry out the moulding as shown in the illustration.

## HINT:

Tape the remover tip before use.