

# POWER STEERING ECU ASSY

5009B-01

## REPLACEMENT

1. PRECAUTION (SEE PAGE 60-1)
2. REMOVE REAR FLOOR BOARD NO.2 (SEE PAGE 21-116)
3. REMOVE DECK FLOOR BOX REAR (SEE PAGE 21-116)
4. REMOVE REAR FLOOR BOARD NO.3 (SEE PAGE 21-116)
5. DISCONNECT BATTERY NEGATIVE TERMINAL (SEE PAGE 60-1)
6. REMOVE INSTRUMENT PANEL REGISTER ASSY NO.1 (SEE PAGE 71-7)
7. REMOVE INSTRUMENT PANEL FINISH PANEL SUB-ASSY LOWER (SEE PAGE 71-7)
8. REMOVE INSTRUMENT PANEL FINISH PANEL SUB-ASSY UPPER (SEE PAGE 71-7)
9. REMOVE INSTRUMENT PANEL REGISTER ASSY NO.3 (SEE PAGE 71-7)
10. REMOVE INSTRUMENT PANEL REGISTER ASSY NO.4 (SEE PAGE 71-7)
11. REMOVE INSTRUMENT PANEL REGISTER ASSY NO.2 (SEE PAGE 71-7)
12. REMOVE MULTI-DISPLAY ASSY (SEE PAGE 71-7)
13. REMOVE GLOVE COMPARTMENT DOOR STOPPER SUB-ASSY (SEE PAGE 71-7)
14. REMOVE GLOVE COMPARTMENT DOOR ASSY (SEE PAGE 71-7)
15. REMOVE GLOVE COMPARTMENT DOOR (SEE PAGE 71-7)
16. REMOVE INSTR PANEL SPEAKER PANEL SUB-ASSY NO.1 W/CTR SPEAKER (W PREMIUM SOUND SYSTEM) (SEE PAGE 71-7)
17. REMOVE FRONT PILLAR GARNISH CORNER PIECE LH (SEE PAGE 71-7)
18. REMOVE FRONT PILLAR GARNISH CORNER PIECE RH (SEE PAGE 71-7)
19. REMOVE FRONT PILLAR GARNISH LH (SEE PAGE 71-7)
20. REMOVE FRONT PILLAR GARNISH RH (SEE PAGE 71-7)
21. DISCONNECT PASSENGER AIRBAG CONNECTOR (SEE PAGE 71-7)
22. REMOVE INSTRUMENT PANEL SUB-ASSY W/PASSENGER AIRBAG ASSY (SEE PAGE 71-7)

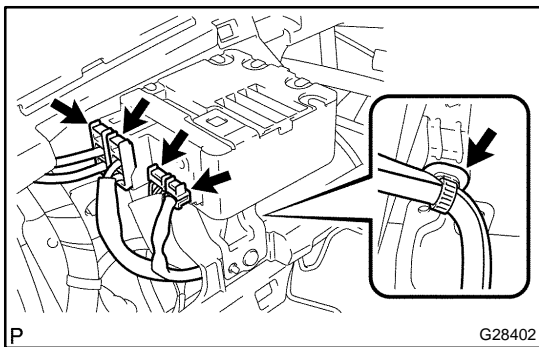

### 23. REMOVE POWER STEERING ECU ASSY

- (a) Separate the torque sensor wire harness clamp from the power steering ECU.

#### NOTICE:

**Be careful not to damage the torque sensor wire harness clamp.**

- (b) Disconnect the 4 connectors.

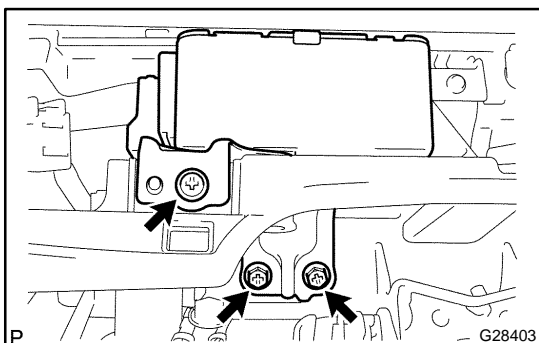

- (c) Remove the 3 screws and the power steering ECU assy.

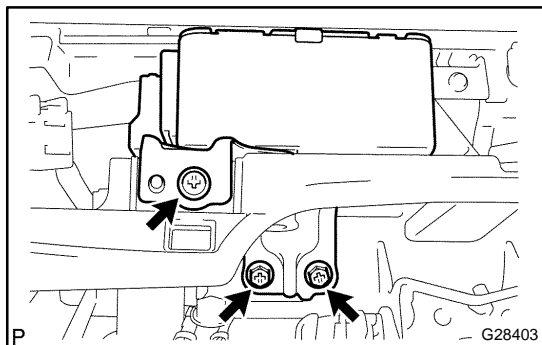

#### 24. INSTALL POWER STEERING ECU ASSY

- (a) Install the power steering ECU assy with the 3 screws.  
**Torque: 5.0 N·m (50 kgf·cm, 44 in·lbf)**

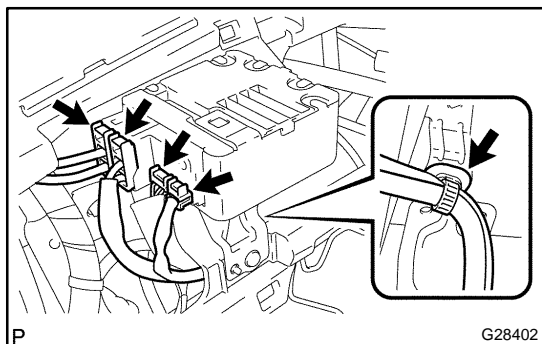

- (b) Connect the 4 connectors.  
 (c) Install the torque sensor wire harness clamp to the power steering ECU.

#### 25. INSTALL INSTRUMENT PANEL SUB-ASSY W/PASSENGER AIRBAG ASSY (SEE PAGE 71-7)

#### 26. CONNECT BATTERY NEGATIVE TERMINAL (SEE PAGE 19-2)

#### 27. INSTALL REAR FLOOR BOARD NO.3

#### 28. INSTALL DECK FLOOR BOX REAR

#### 29. INSTALL REAR FLOOR BOARD NO.2

#### 30. INSPECT SRS WARNING LIGHT (SEE PAGE 05-1397)

#### 31. PERFORM CALIBRATION OF TORQUE SENSOR ZERO POINT (SEE PAGE 05-1211)

#### 32. PERFORM INITIALIZATION (SEE PAGE 01-28)

#### HINT:

When disconnecting the negative battery terminal, it is necessary to initialize other systems.