

STABILIZER BAR FRONT

REPLACEMENT

2601A-01

HINT:

- COMPONENTS: See page 26-3
 - Use the same procedures for the RH side and LH side.
 - The procedures listed below are for the LH side.
1. **PLACE FRONT WHEELS FACING STRAIGHT AHEAD**
 2. **REMOVE COLUMN HOLE COVER SILENCER SHEET (SEE PAGE 51-6)**
 3. **SEPARATE STEERING SLIDING YOKE SUB-ASSY (SEE PAGE 51-6)**
 4. **SEPARATE STEERING COLUMN HOLE COVER SUB-ASSY NO.1 (SEE PAGE 51-6)**
 5. **REMOVE FRONT WHEEL**

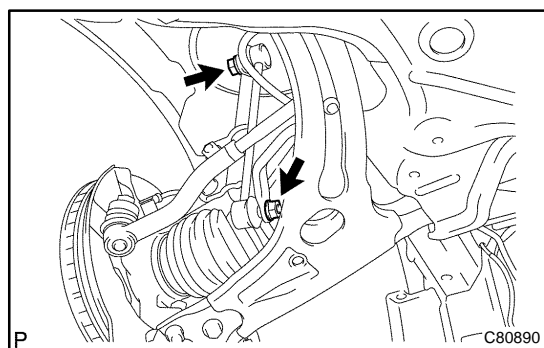

6. REMOVE FRONT STABILIZER LINK ASSY

- (a) Remove the 2 nuts and front stabilizer link assy LH.

HINT:

Use a hexagon wrench (6 mm) to hold the stud if the ball joint turns together with the nut.

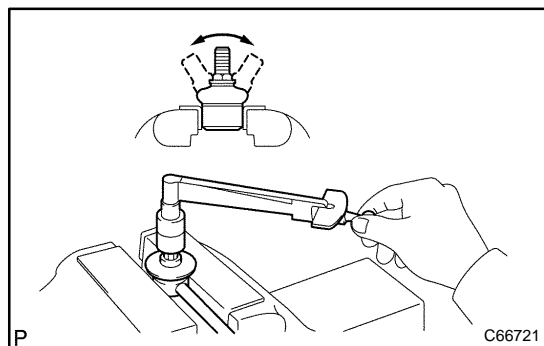

7. INSPECT FRONT STABILIZER LINK ASSY

- (a) Flip the ball joint stud back and forth 5 times as shown in the illustration before installing the nut.
- (b) Use a torque wrench to turn the nut continuously at a rate of 2 to 4 seconds per turn. Take the torque reading on the 5th turn.

Turning torque:

0.05 to 1.96 N·m (0.5 to 20 kgf·cm, 0.4 to 17.4 in.-lbf)

- (c) Check the dust cover for cracks or grease leakage.
- If the value is not within the specified range, replace the front stabilizer link assy with a new one.

8. SEPARATE TIE ROD END SUB-ASSY LH (SEE PAGE 30-7)

SST 09628-00011

9. SEPARATE TIE ROD END SUB-ASSY RH

SST 09628-00011

HINT:

Remove the RH side following the same procedures as with the LH side.

10. REMOVE FLOOR PANEL BRACE FRONT (SEE PAGE 15-2)

11. REMOVE EXHAUST PIPE ASSY FRONT (SEE PAGE 15-2)

12. SEPARATE FRONT STABILIZER BRACKET NO.1 LH

- (a) Remove the 2 bolts and the stabilizer bracket No.1 LH from the front suspension crossmember sub-assy.

13. SEPARATE FRONT STABILIZER BRACKET NO.1 RH

HINT:

Remove the RH side following the same procedures as with the LH side.

2004 Prius – Preliminary Release (RM1075U)

14. REMOVE STEERING INTERMEDIATE SHAFT (SEE PAGE 51-6)
15. REMOVE STEERING COLUMN HOLE COVER SUB-ASSY NO.1 (SEE PAGE 51-6)
16. REMOVE STEERING GEAR ASSY (SEE PAGE 51-6)
17. REMOVE FRONT STABILIZER BAR BUSH NO.1
 - (a) Remove the 2 front stabilizer bar bushes No.1 from the stabilizer bar.
18. REMOVE STABILIZER BAR FRONT
 - (a) Remove the front stabilizer bar from the right side of the vehicle.
19. INSTALL STABILIZER BAR FRONT
 - (a) Insert the front stabilizer bar from the right side of the vehicle.

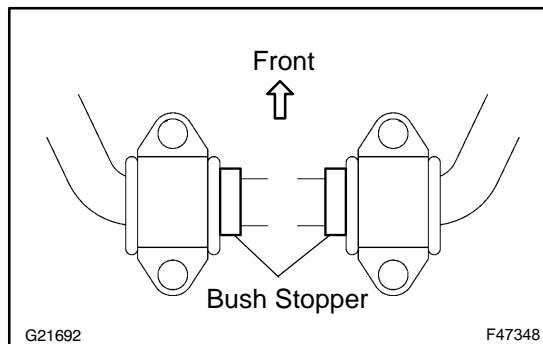

20. INSTALL FRONT STABILIZER BAR BUSH NO.1

- (a) Install the bush to the outer side of the bush stopper on the stabilizer bar.

NOTICE:

- Place the cutout of the stabilizer bush facing the rear side.
- Ensure the right of left deviation of the stabilizer bar is 5mm or less.

21. INSTALL STEERING GEAR ASSY (SEE PAGE 51-6)
22. INSTALL STEERING COLUMN HOLE COVER SUB-ASSY NO.1 (SEE PAGE 51-6)
23. INSTALL STEERING INTERMEDIATE SHAFT (SEE PAGE 51-6)
24. INSTALL FRONT STABILIZER BRACKET NO.1 LH
 - (a) Install the stabilizer bracket No.1 LH to the front suspension crossmember sub-assy with the 2 bolts.
Torque: 19 N·m (194 kgf·cm, 14 ft·lbf)
25. INSTALL FRONT STABILIZER BRACKET NO.1 RH

HINT:
Install the RH side following the same procedures as with the LH side.
26. INSTALL EXHAUST PIPE ASSY FRONT (SEE PAGE 15-2)
27. INSTALL FLOOR PANEL BRACE FRONT (SEE PAGE 15-2)

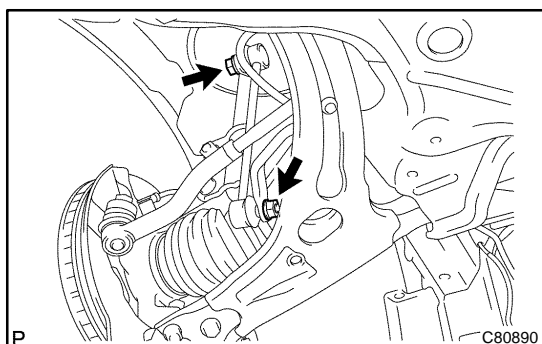

28. INSTALL FRONT STABILIZER LINK ASSY

- (a) Install the front stabilizer link assy LH with the 2 nuts.
Torque: 74 N·m (755 kgf·cm, 55 ft·lbf)

HINT:

Use a hexagon wrench (6 mm) to hold the stud if the ball joint turns together with the nut.

29. INSTALL TIE ROD END SUB-ASSY LH (SEE PAGE 30-7)
30. INSTALL TIE ROD END SUB-ASSY RH

HINT:

Install the RH side following the same procedures as with the LH side.

31. **INSTALL FRONT WHEEL**
Torque: 103 N·m (1,050 kgf·cm, 76 ft·lbf)
32. **INSPECT AND ADJUST FRONT WHEEL ALIGNMENT (SEE PAGE [26-6](#))**