

SHIFT CONTROL ACTUATOR ASSY REPLACEMENT

2200W-01

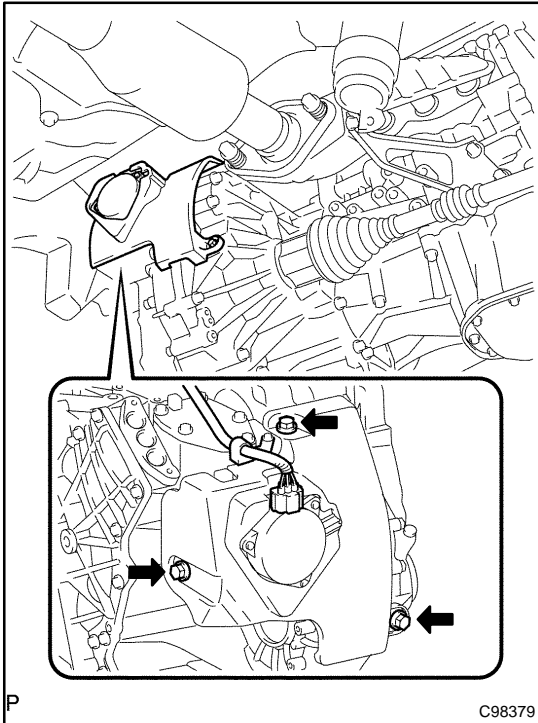

1. REMOVE SHIFT CONTROL ACTUATOR ASSY

- (a) Disconnect the connector.
- (b) Remove the 3 bolts. Remove the transmission case cover from the hybrid vehicle transaxle.

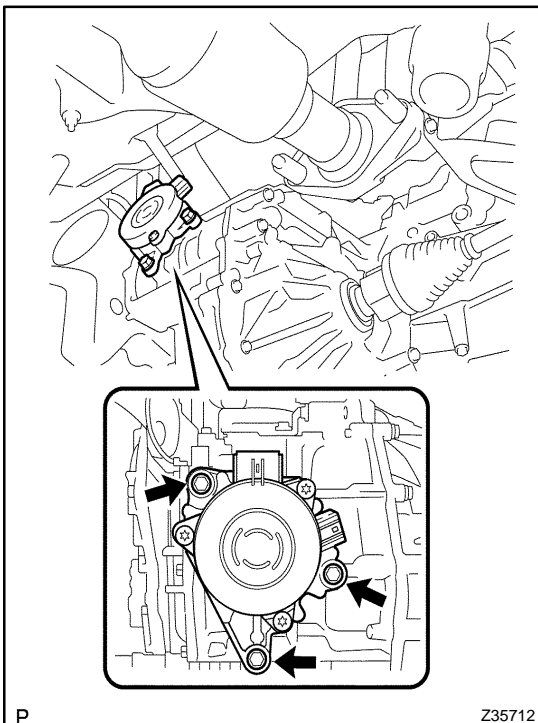

- (c) Remove the 3 bolts. Remove the shift control actuator assy from the hybrid vehicle transaxle.

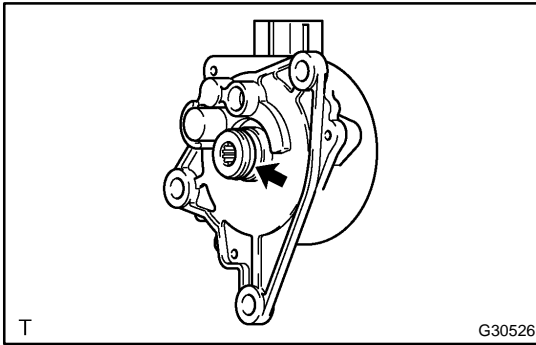

2. INSTALL SHIFT CONTROL ACTUATOR ASSY

- (a) Apply a small amount of ATF WS to the O-ring.

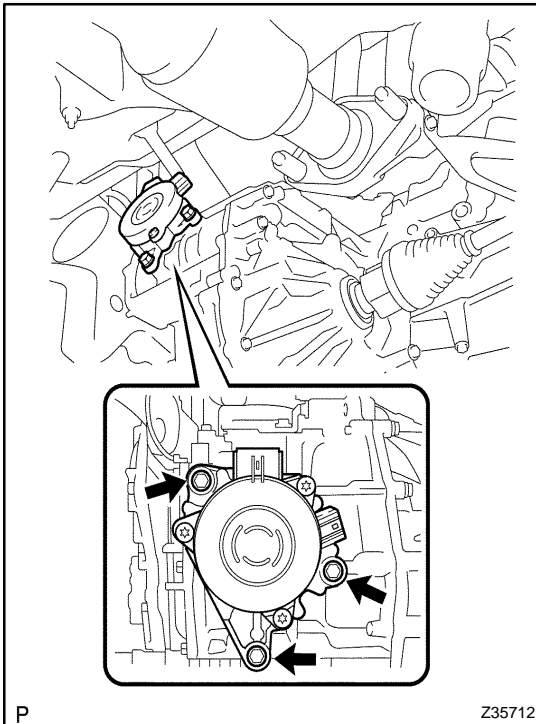

- (b) Install the shift control actuator assy to the hybrid vehicle transaxle using the 3 bolts.

Torque: 16 N·m (160 kgf·cm, 12 ft·lbf)

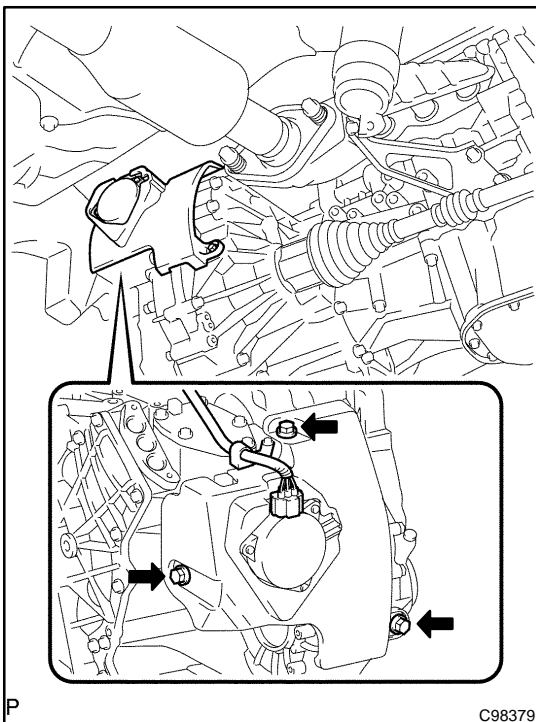

- (c) Install the transmission case cover to the hybrid vehicle transaxle using the 3 bolts.

Torque: 7.0 N·m (71 kgf·cm, 62 in.-lbf)

- (d) Connect the connector.